

# RAL0-26H28001

## INTERIOR

One Circuit Track Hardware - Track

● Dry location



### Ordering Information

Clear Form

Date :	<input type="text"/>	Quantity :	<input type="text"/>
Project :	<input type="text"/>	Note :	<input type="text"/>
Type :	<input type="text"/>		<input type="text"/>

### Specifications

Isolator | Example Code: RAL0-26H28001-BK

Product	Finish <sup>1</sup>
RAL0-26H28001	<div><div>BK</div>black</div> <div><div>WH</div>white</div>

### Important Notes

#### Specification

1. Refer to Appendix or MP Lighting website for track system with different finish options.

### Application

Environment	Dry Location approved. IP 20.
Mounting	For ceiling mounting or suspension mounting.
Compatible Fixtures	L225M (4W and 8W), L199 (4W and 8W), L698 (4W and 8W), & P96S-LED (8W).

### Electrical

Electrical	<b>Low Voltage 1 Circuit Track:</b> 60W/12V <b>Compatible Drivers:</b> LED60W12VP-01B and LED60W12VZ-01B
------------	-------------------------------------------------------------------------------------------------------------

### Construction

Weight	N/A
Material	<b>Extrusion:</b> aluminum <b>Conductor:</b> copper

## Mounting Options & Dimensions

### Dimensions

Isolator

Side View

3D View

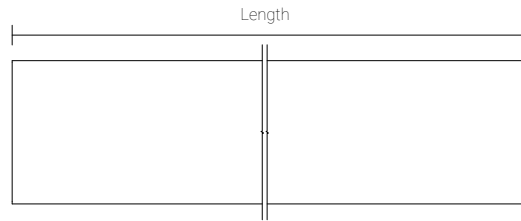
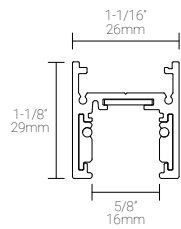

**1CT Track** | 60W driver for 1 to 6 8W fixtures. All 1CT fixtures comes with ECN0-1C16001-BK Track Adapter

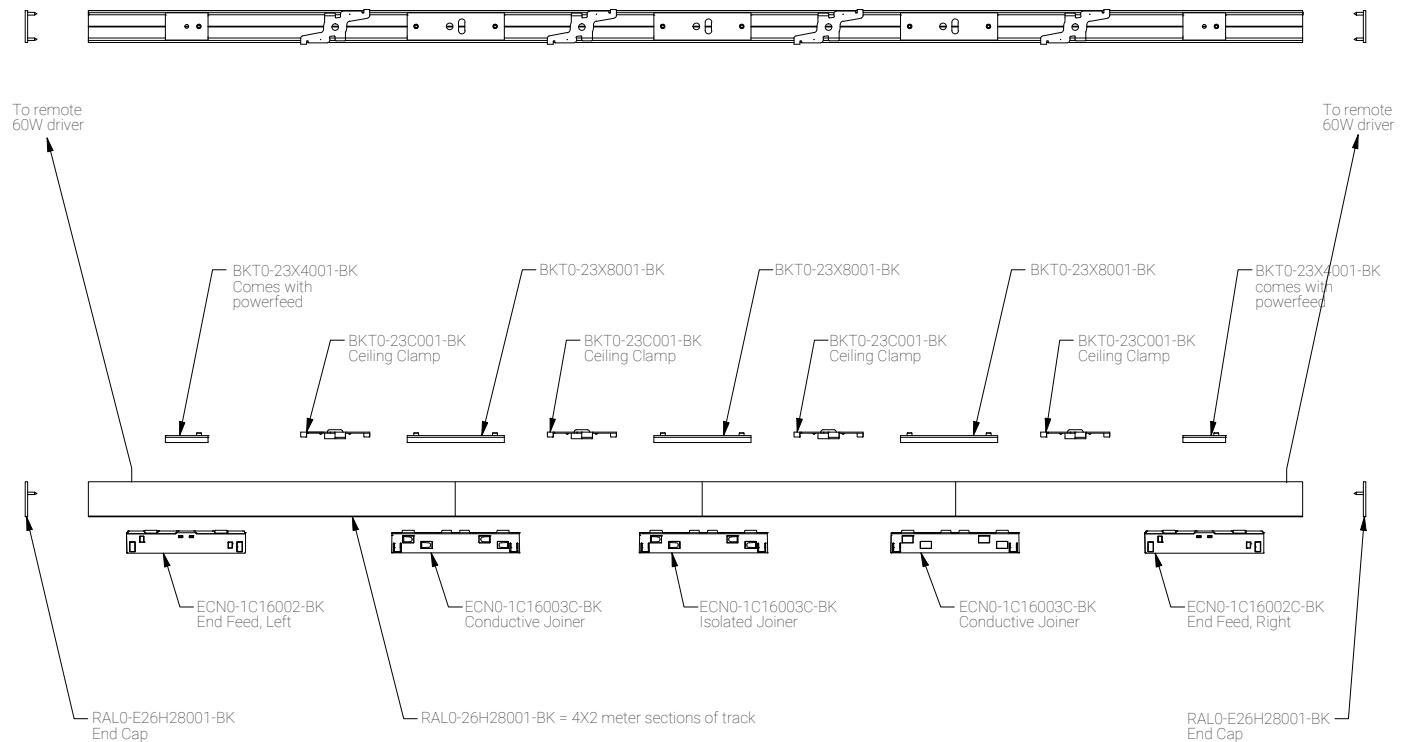

## Appendix

### Aluminum Finishes



BK black



WH white